



**Natural Stone Shower Basin**

Thank you for selecting our Buffalo Stone Shower Basin. The design of this product combines the beauty of natural stone with a simple installation.

We hope you enjoy your new stone shower basin. If you have questions or encounter any installation issues, feel free to contact us.

## Installation Instructions

### 1. PREPARE SUBSTRATE FOR INSTALLATION

- Provide a structurally sound substrate that is level and clean. (see ASTM C627)
- Locate center of drain per Architectural Plans.
- Provide a 5" diameter hole 2" deep minimum in the substrate for the drain assembly.

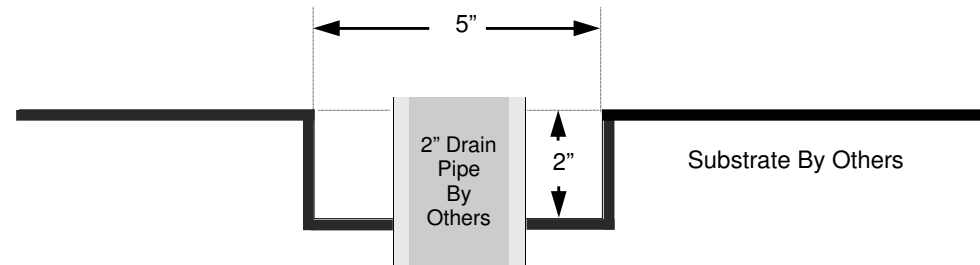

### 2. CENTER BASIN OVER THE DRAIN PIPE

Note: CTC recommends that the basin is bedded and leveled in a plaster or cementitious material.

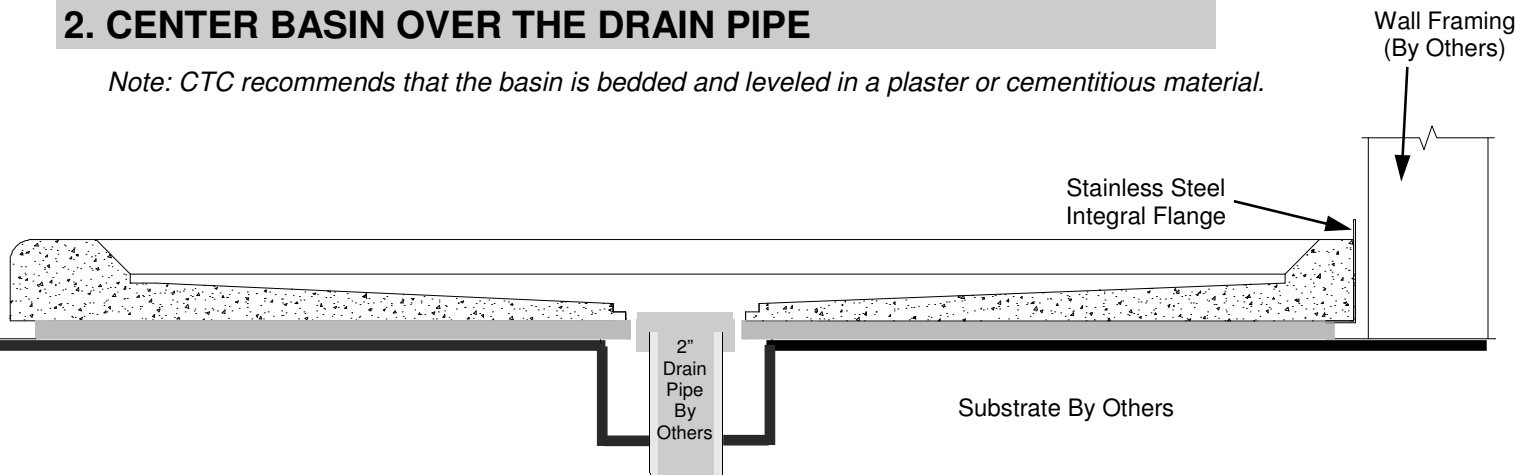

### 3. ATTACH DRAIN ASSEMBLY

#### No-Caulk Version

1. Apply a 1/4" bead of silicone caulk on the closest edge to the drain hole.
2. Screw drain housing into the integral drain flange until top of drain housing is 1/8" lower than the shower floor surface.
3. Insert gasket between drain housing and pipe.
4. Set gasket with the gasket set ring.
5. Insert stainless steel strainer.

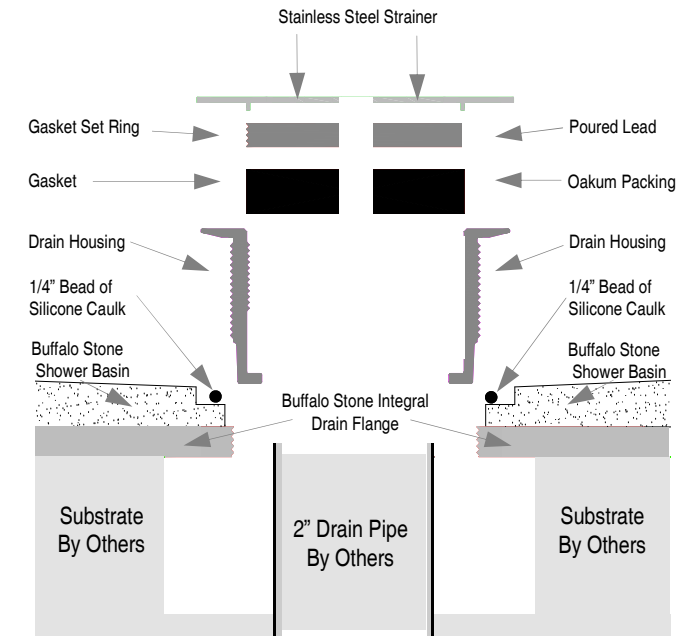

#### Lead Joint Version

1. Apply a 1/4" bead of silicone caulk on the closest edge to the drain hole.
2. Screw drain housing into the integral drain flange until top of drain housing is 1/8" lower than the shower floor surface.
3. Assemble drain per local plumbing codes.
4. Insert stainless steel strainer.

### 4. COMPLETED INSTALLATION

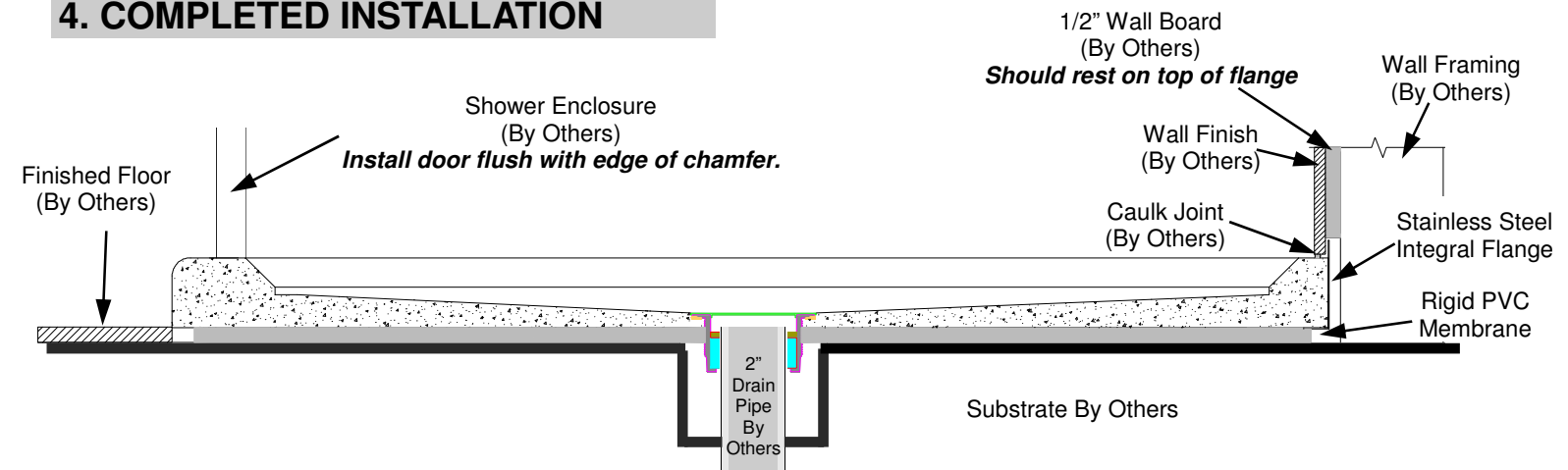

### 5. CARE AND CLEANING

- Using the proper cleaners and sealers will help keep your Buffalo Stone Shower Basin looking like new. Use cleaners specifically formulated for natural stone, with a neutral ph-balance or a mild detergent. Never anything abrasive.
- Shower basins are sealed in the factory. They can be resealed as needed to help protect against dirt, oil and stains.
- Please call us for recommendations on suitable manufacturers of stone cleaners and sealers. 800-236-5230.

**PRODUCT DATA**

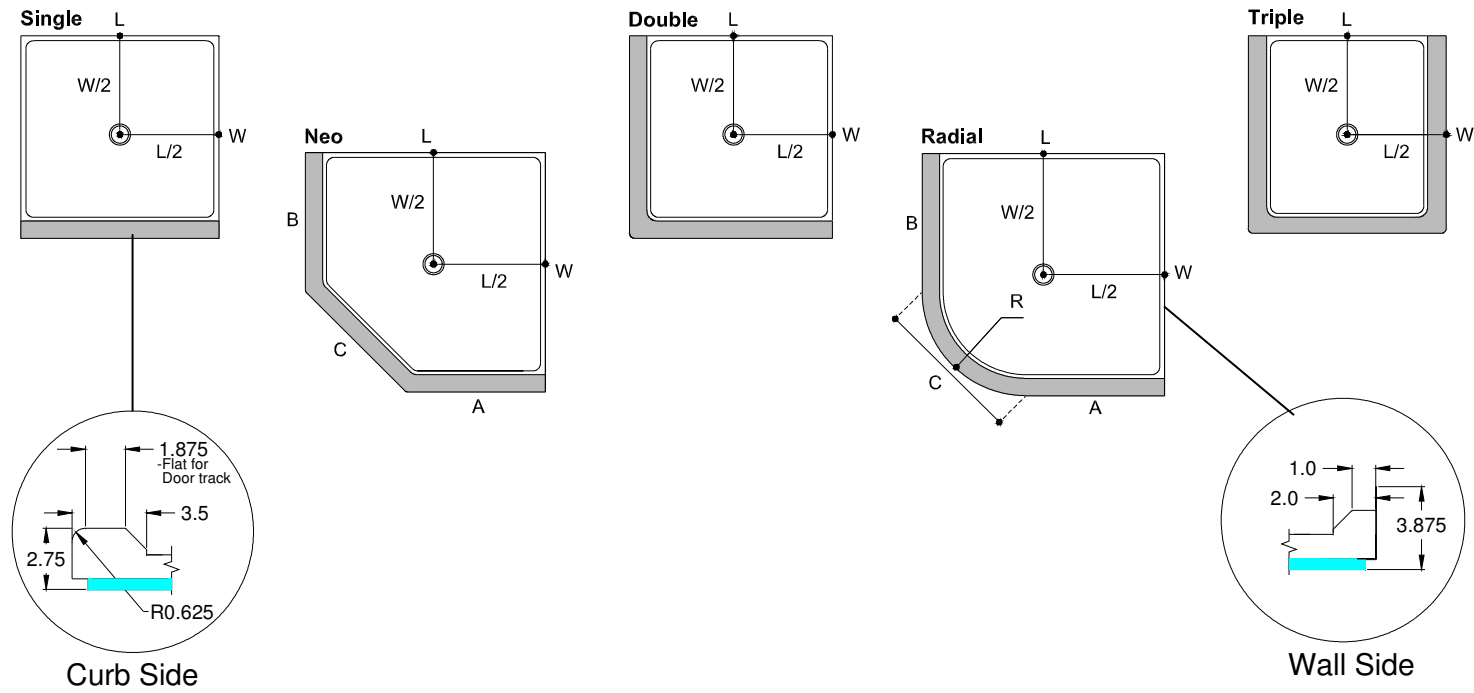

BUFFALO



**Natural Stone Shower Basin**

**Ceramic Tool Company, Inc.**  
 N16 W23250 Stoneridge Drive  
 Waukesha, WI 53188  
 262.513.9331 • Fax 262.513.9332

www.ceramictool.com • ctc@ceramictool.com

**Installation Instructions**

**June 2006**

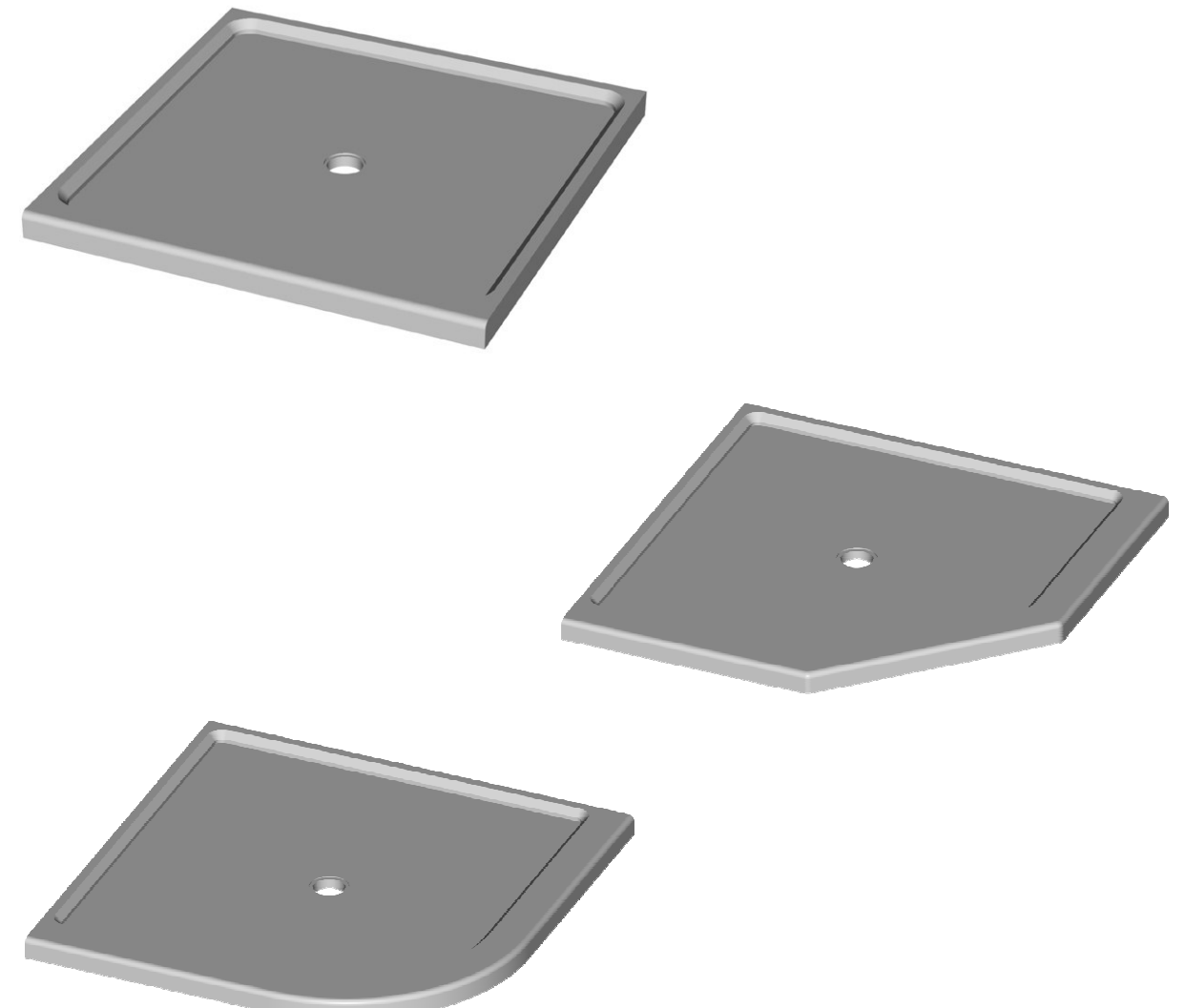

Model	Drain R.O. (From Framing)		Actual Basin Dimensions (in inches)						Unit Weight (lbs.)	Shipping Weight (lbs.)
	X	Y	Length	Width	A	B	C	R		
Maximum 60"	L / 2	W / 2	L - 1/2	W - 1/2	A - 1/4	B - 1/4	$C = \sqrt{(L-A)^2 + (W-B)^2}$	L - A	.13 lbs. / in. <sup>2</sup>	.15 lbs. / in. <sup>2</sup>

**ARCHITECTURAL SPECIFICATION**

Furnish and install Buffalo Stone Shower Basins by Ceramic Tool Company 800/236-5230. All basins shall be fabricated from natural stone with a slip-resistant floor that does not interfere with the flow of water. Basins to have a stainless steel flange on all non-curb sides. Stone color to be specified by architect/designer. Basins details, including size and shape, per construction drawings.

**PACKAGING and SHIPPING**

- Each Buffalo Stone Shower Basin is individually crated to provide protection during shipping and delivery.
- Crates are shipped on pallets (8 per pallet max.) to provide ease of unloading and movement throughout construction site.
- Packaging allows for inspection without removing protective crating.
- Upon receipt of Basins, immediately inspect all cartons for damage.
- Open crate prior to signing Bill of Lading.
- CTC reserves the right to select the method of shipment and carrier.
- CTC is not liable for damages to Basins that occur in transit.